



LIGHTING SCIENCES CANADA LTD.

440 Phillip St., Unit 19, Waterloo, Ontario, Canada N2L 5R9
Tel: (519) 746-3140 Fax: (519) 746-3156 lsc@lightingsciences.ca

CERTIFIED TEST REPORT NO. LSC B711

HYBRIDYNE-RHS KAZEKAMOME LIGHT MODULE CAT. NO. FY08TWF1362
WITH TRANSLUCENT LENS
ONE 20W T8 CIRCULAR COMPACT FLUORESCENT LAMP. LUMEN OUTPUT = 1027 LMS.
(12.0 VDC, 1.61 ADC)

IESNA CUTOFF CLASSIFICATION: NON-CUTOFF

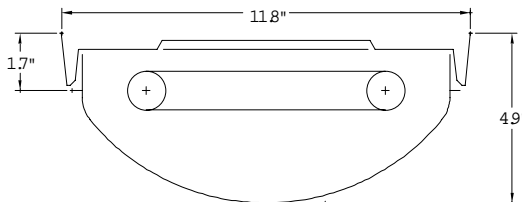

REPORT PREPARED FOR:
CERTIFIED BY:

HYBRIDYNE-RHS INC.
NEWMARKET, ONTARIO

DATE: MAY 31, 2007

LABORATORY RESULTS MAY NOT BE REPRESENTATIVE OF FIELD PERFORMANCE.
ABSOLUTE PHOTOMETRY TAKEN. BALLAST FACTORS HAVE BEEN APPLIED.

TESTED IN 16 VERTICAL PLANES, ALL PLANES AVERAGED

VERTICAL TEST INCREMENTS ARE 2.5 DEGREES.

TEST DISTANCE EXCEEDS FIVE TIMES THE GREATEST
LUMINOUS OPENING OF LUMINAIRE.

TESTED IN ACCORDANCE WITH IES RECOMMENDED PROCEDURES

LIGHTING SCIENCES CANADA LTD.
440 PHILLIP ST., UNIT 19
WATERLOO, ONTARIO

CERTIFIED TEST REPORT NO. LSC B711

HYBRIDYNE-RHS KAZEKAMOME LIGHT MODULE CAT. NO. FY08TWF1362
WITH TRANSLUCENT LENS
ONE 20W T8 CIRCULAR COMPACT FLUORESCENT LAMP. LUMEN OUTPUT = 1027 LMS.
(12.0 VDC, 1.61 ADC)

UTILIZATION TABLE

CO-EFFICIENT OF UTILIZATION

RATIO	HOUSE SIDE	STREET SIDE	TOTAL
.5	.171	.171	.341
1.0	.278	.278	.557
1.5	.336	.336	.672
2.0	.370	.370	.739
2.5	.390	.390	.779
3.0	.402	.402	.805
3.5	.413	.413	.826
4.0	.418	.418	.837
5.0	.428	.428	.856
TOTAL:	.460	.460	.921

PERCENTAGE OUTPUTS

DOWNWARD:	STREET SIDE =	46.0%
	HOUSE SIDE =	46.0%
	TOTAL =	92.1%
UPWARD:	STREET SIDE =	3.9%
	HOUSE SIDE =	3.9%
	TOTAL =	7.9%
TOTAL EFFICIENCY	=	100.0%

LIGHTING SCIENCES CANADA LTD.
 440 PHILLIP ST., UNIT 19
 WATERLOO, ONTARIO

CERTIFIED TEST REPORT NO. LSC B711

HYBRIDYNE-RHS KAZEKAMOME LIGHT MODULE CAT. NO. FY08TWF1362
 WITH TRANSLUCENT LENS
 ONE 20W T8 CIRCULAR COMPACT FLUORESCENT LAMP. LUMEN OUTPUT = 1027 LMS.
 (12.0 VDC, 1.61 ADC)

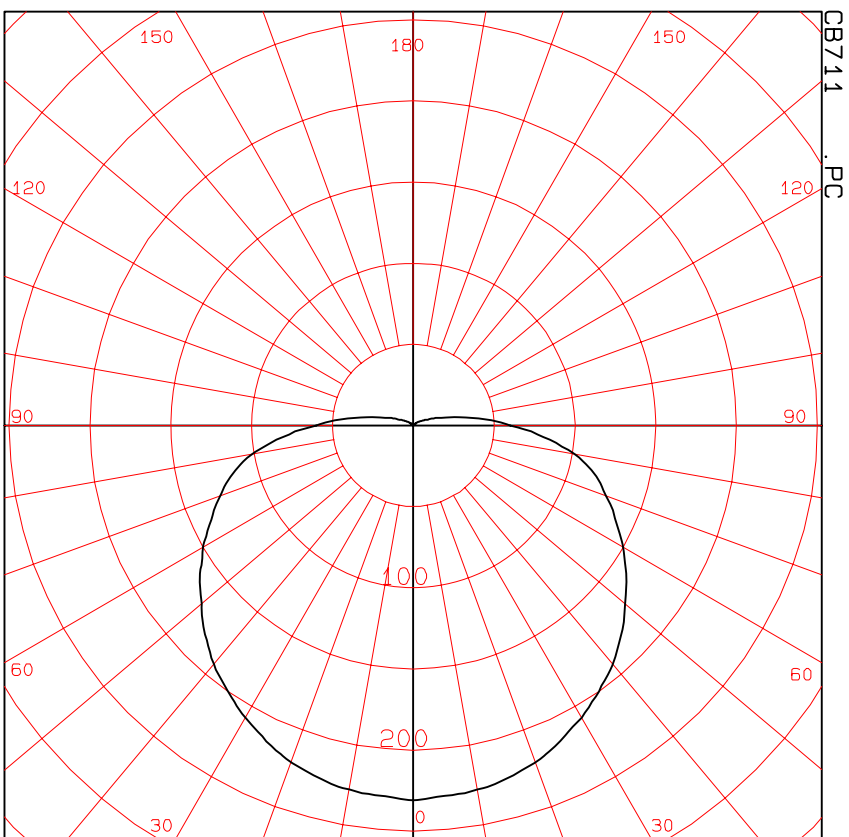

CANDLEPOWER IN MAX. PLANE	
ANGLE	CANDLEPOWER
.0	231
5.0	229
10.0	228
15.0	225
20.0	221
25.0	215
30.0	208
35.0	200
40.0	192
45.0	182
50.0	171
52.5	166
55.0	161
57.5	155
60.0	150
62.5	144
65.0	138
67.5	133
70.0	127
72.5	122
75.0	116
77.5	109
80.0	101
82.5	91
85.0	81
87.5	71
90.0	60
95.0	44
105.0	18
115.0	8
125.0	3
135.0	0
145.0	0
155.0	0
165.0	0
175.0	0
180.0	0

MAXIMUM CANDLEPOWER: 231
 VERT. ANGLE OF MAXIMUM .0
 ALL PLANES IDENTICAL

ISOLUX

TEST REPORT NO. B711

HYBRIDYNE-RHS KAZEKAMOME LIGHT MODULE CAT. NO. FY08TWF1362
WITH TRANSLUCENT LENS

ONE 20W T8 CIRCULAR COMPACT FLUORESCENT LAMP. LUMEN OUTPUT = 1027 LMS.
(12.0 VDC, 1.61 ADC)

MOUNTING HEIGHT FOR ISOLUX 4.0 METERS

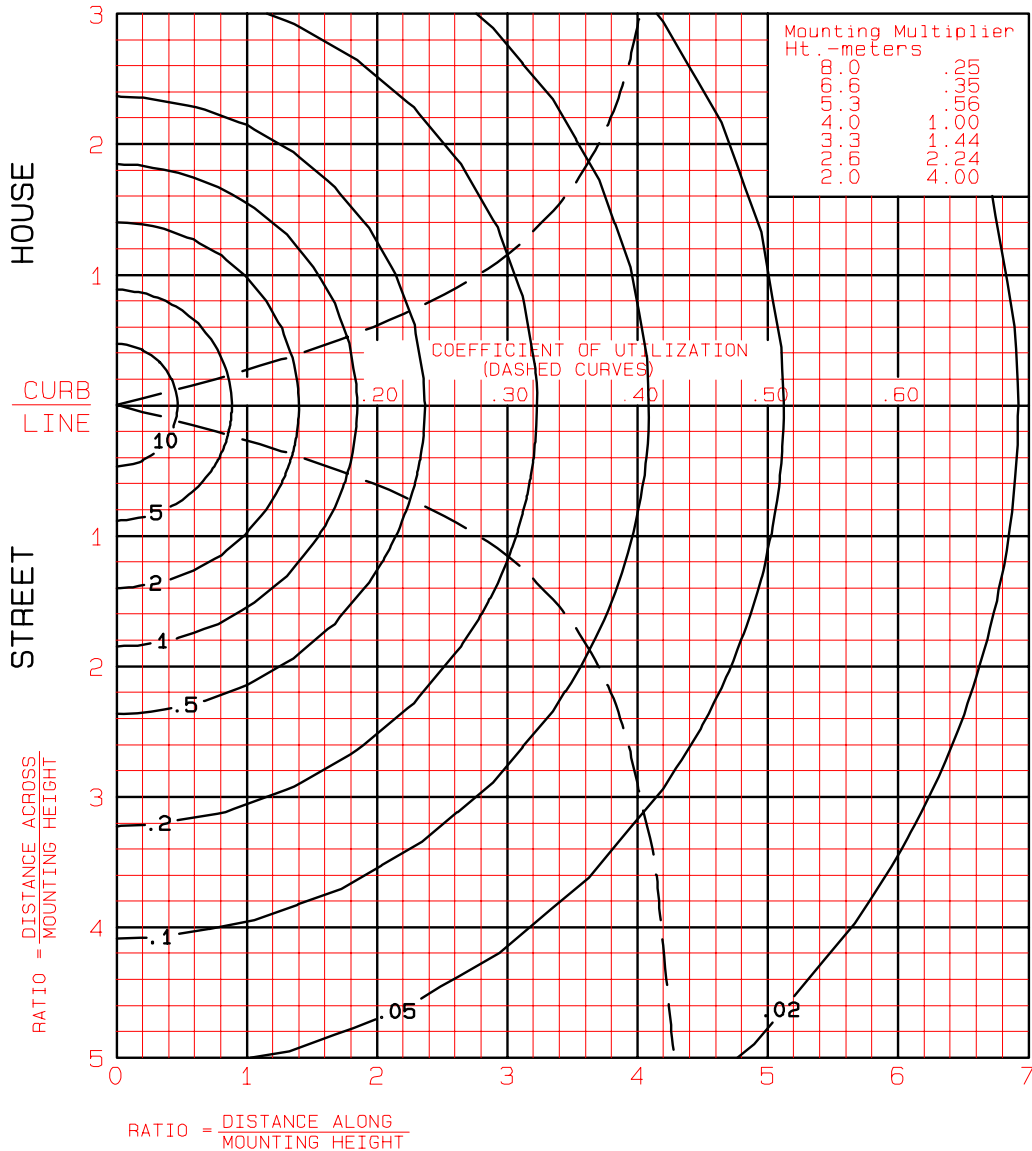

CERTIFIED TEST REPORT NO. LSC B711

** LUX TABLE FOR SINGLE LUMINAIRE AT 4.0 METERS **

LATERAL RATIOS	+	+	+	+	+	+	+	+	+	+	+	+	+	+	+
-3.00	.24	.23	.21	.17	.14	.10	.084	.064	.050	.039	.030	.024	.019	.015	.013
-2.50	.42	.39	.33	.26	.20	.14	.10	.080	.060	.045	.035	.027	.021	.017	.014
-2.00	.79	.73	.58	.42	.29	.20	.14	.099	.071	.052	.039	.030	.023	.018	.015
-1.50	1.6	1.4	1.0	.67	.42	.26	.17	.11	.082	.059	.043	.033	.025	.019	.015
-1.00	4.0	3.2	1.9	1.0	.58	.33	.21	.13	.092	.064	.047	.035	.026	.020	.016
-.50	9.5	6.8	3.2	1.4	.73	.39	.23	.14	.099	.068	.049	.036	.027	.021	.016
HOUSE	CURB LINE														
STREET	14.	9.5	4.0	1.6	.79	.42	.24	.15	.10	.070	.050	.037	.028	.021	.017
.50	9.5	6.8	3.2	1.4	.73	.39	.23	.14	.099	.068	.049	.036	.027	.021	.016
1.00	4.0	3.2	1.9	1.0	.58	.33	.21	.13	.092	.064	.047	.035	.026	.020	.016
1.50	1.6	1.4	1.0	.67	.42	.26	.17	.11	.082	.059	.043	.033	.025	.019	.015
2.00	.79	.73	.58	.42	.29	.20	.14	.099	.071	.052	.039	.030	.023	.018	.015
2.50	.42	.39	.33	.26	.20	.14	.10	.080	.060	.045	.035	.027	.021	.017	.014
3.00	.24	.23	.21	.17	.14	.10	.084	.064	.050	.039	.030	.024	.019	.015	.013
3.50	.15	.14	.13	.11	.099	.080	.064	.051	.041	.033	.026	.021	.017	.014	.012
4.00	.10	.099	.092	.082	.071	.060	.050	.041	.033	.027	.022	.018	.015	.012	.010
4.50	.070	.068	.064	.059	.052	.045	.039	.033	.027	.023	.019	.016	.013	.011	.009
5.00	.050	.049	.047	.043	.039	.035	.030	.026	.022	.019	.016	.014	.012	.010	.008
	0.0	0.5	1.0	1.5	2.0	2.5	3.0	3.5	4.0	4.5	5.0	5.5	6.0	6.5	7.0
	LONGITUDINAL MOUNTING HEIGHT RATIOS														

CORRECTION FACTORS FOR OTHER MOUNTING HEIGHTS: SEE ISOLUX PAGE